

Fabric Stretch Display 10'

Fabric Stretch Display 10'

Fabric Stretch Display 10ft displays have customary frame features, are portable and come in Straight, Vertical Curved, Horizontal Curved and Serpentine Curved options. The economy aluminum tube frame features bungee cords, rounded corners and comes with a one year limited warranty. Simply pull the pillowcase fabric graphic over the frame and zip. All displays come with a canvas carry bag.



features and benefits:

- Economy aluminum tube frame features bungee cords and rounded corners
- Easy to store and ship
- Quick to set up
- Kit includes: one frame, pillowcase zipper fabric graphic and canvas carry bag
- One year limited hardware warranty against manufacturer defects

dimensions:

Hardware	Graphic
<p>Assembled unit: 123.625" w x 92.5" h x 13.75" d 3140mm(w) x 2349.5mm(h) x 349.25mm(d)</p> <p>Approximate weight (includes graphic): 22 lbs / 9.98 kgs</p>	<p>Total visual area: 121" w x 90.5" h 3073mm(w) x 2299mm(h)</p> <p>Please be sure to include a 2" bleed around the perimeter.</p> <p>Refer to related graphic template for more information.</p>
<p>Shipping</p> <p>Shipping dimensions: 41.7" l x 11.8" w x 6.3" h 1060mm(l) x 300mm(w) x 160mm(h)</p> <p>Approximate shipping weight: 24 lbs / 10.8 kgs</p>	<p>Visit: www.exhibitors-handbook.com/graphic-templates</p>

additional information:

Graphic material:
dye-sublimation zipper pillowcase fabric



We are continually improving and modifying our product range and reserve the right to vary the specifications without prior notice. All dimensions and weights quoted are approximate and we accept no responsibility for variance. E&OE. See Graphic Templates for graphic bleed specifications.

Assembly:

Assemble unit by laying tubes flat on the floor. Connect the bungee tube rails by pressing the push snap buttons in and sliding over (see drawing below) following the number labels listed, T1 to T1, T2 to T2 and so on.

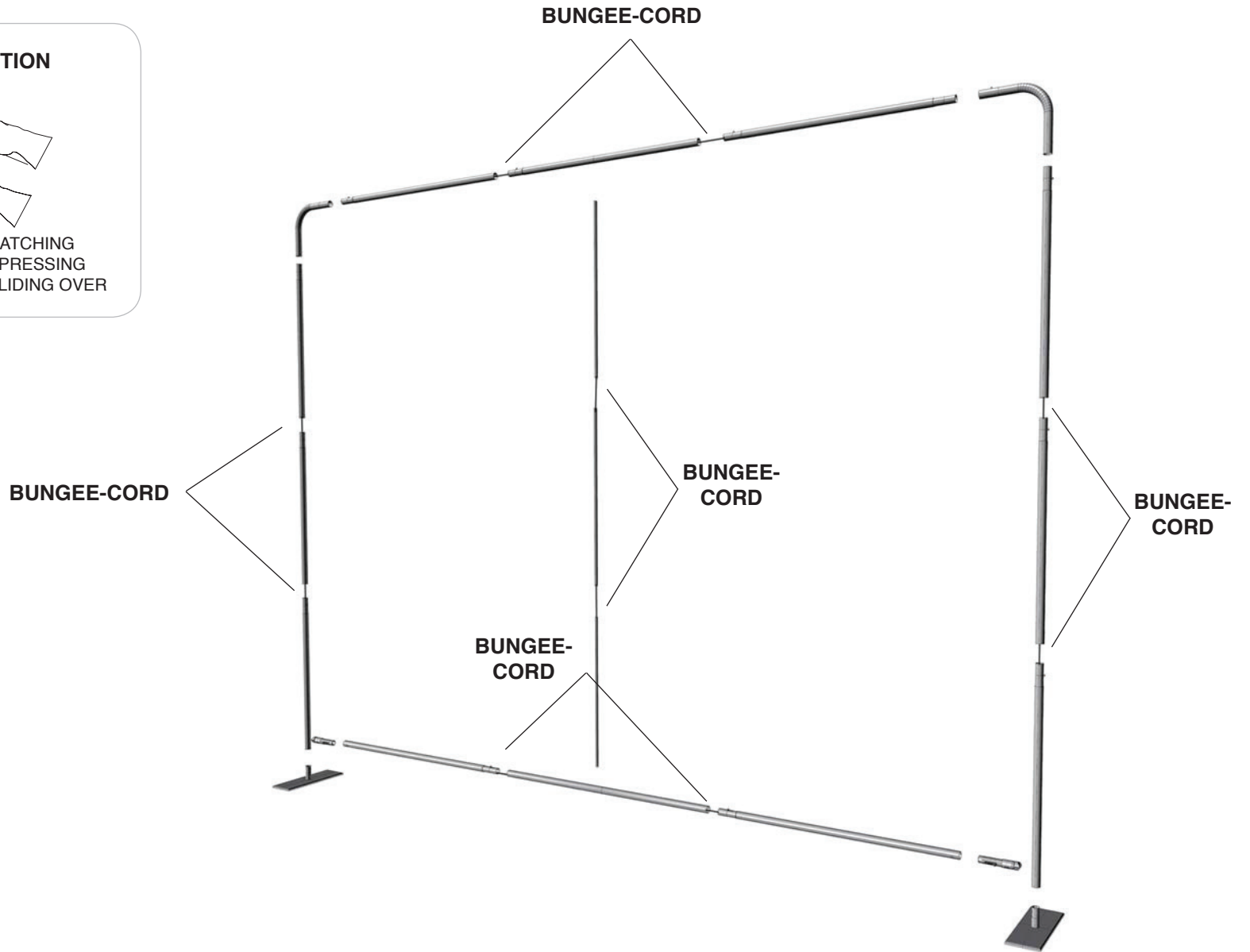
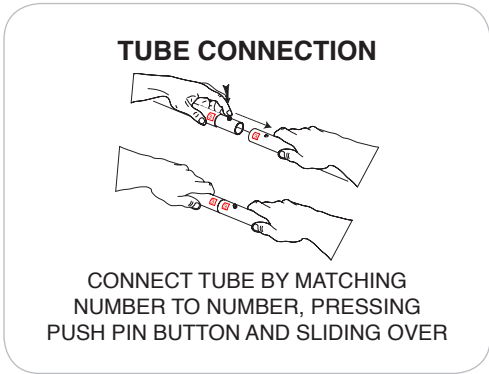

STEP 1: ASSEMBLE FRAME

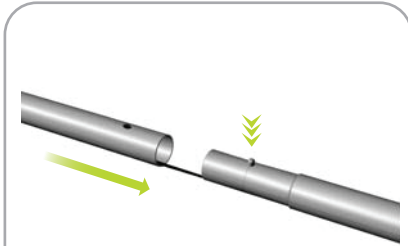

Connect bungee tubes by lining up holes with snap buttons

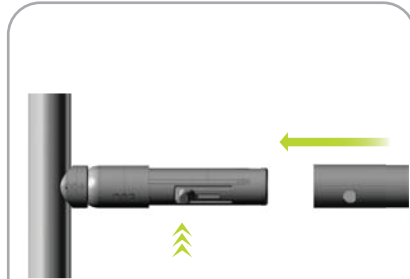

Connect bungee tubes by lining up holes with snap buttons

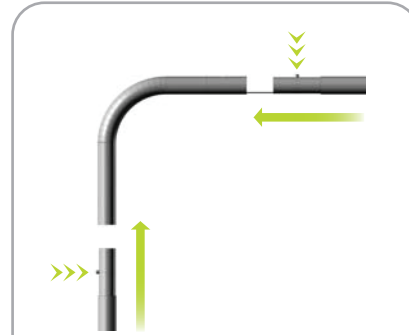

Connect corners of frame by lining up holes with snap buttons



Place the center stability pole in the holes at the top and bottom

STEP 2: ATTACH FEET

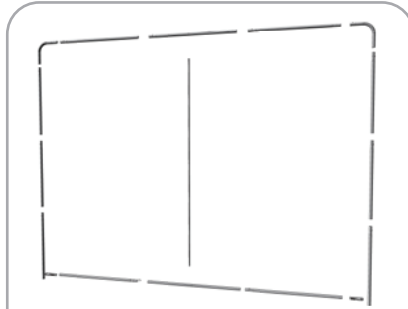

Frame assembly is complete once all sides are connected



Connect frame to feet by lining up holes with snap button on feet

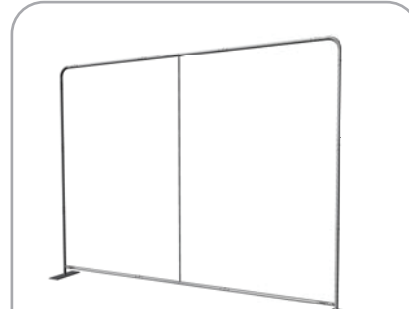

Complete the entire frame assembly

STEP 3: ATTACH GRAPHIC

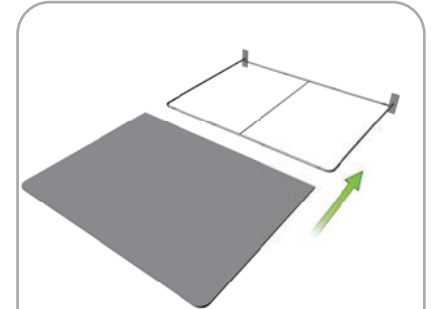

Slide graphic over top of frame



Zip graphic closed along bottom of frame

Need help? 

**See our instructional videos online at
www.StepandRepeatLA.com
or call (818) 434-7591**

**For very urgent emergencies after
hours or on weekends, please email
911@stepandrepeatla.com and we
will get back to you right away.**